

TRAFFIC ENGINEERING TRAFFIC CONTROL REQUIREMENTS



<b>Total Devices:</b>
Barricades: 0
Signs: 10
Channelizers:
Volunteers: 2

 Event signage with directional arrow

 Barricades (#)

 Volunteer

 Turn bay closure (#) channelizers

TRAFFIC ENGINEERING TRAFFIC CONTROL REQUIREMENTS

Huff in Puff Hot Air Balloon Rally  
09-06,07 & 08, 2019  
6:00pm to 9:00pm

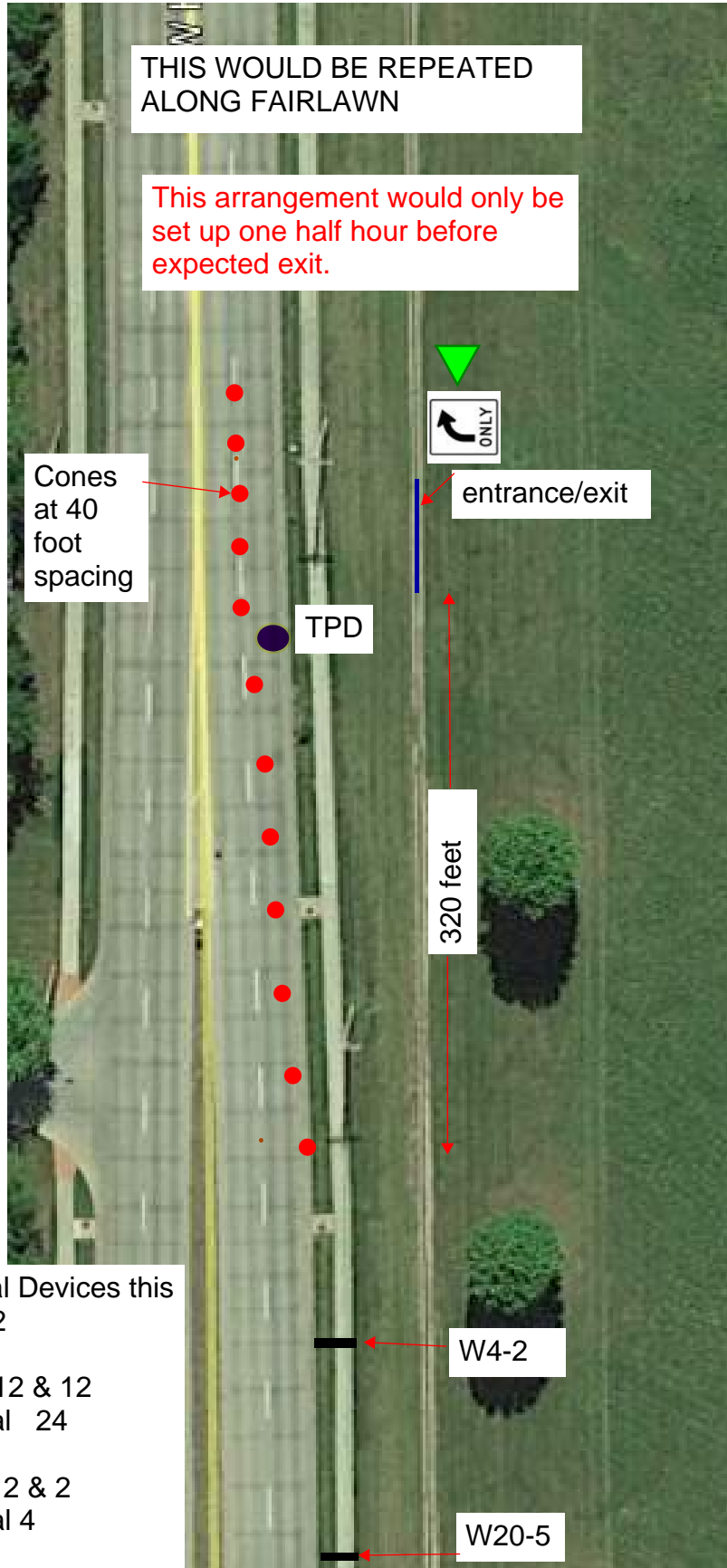

THIS WOULD BE REPEATED ALONG FAIRLAWN

This arrangement would only be set up one half hour before expected exit.

Cones at 40 foot spacing

TPD

ONLY

entrance/exit

320 feet

W4-2

W20-5

Additional Devices this page: X 2

Cones - 12 & 12  
Total 24

Signs 2 & 2  
Total 4