



# **NW Tyler Street Reconstruction Project – Phase 1 (2022 Construction)**

NW Lyman Rd.  
to  
NW Beverly St.

## **PROJECT SCOPE:**

- **Reconstruct Tyler St. from Lyman Rd. to Paramore St.**
- **Add 5' sidewalks, curb & gutter, & storm sewer**
- **Replace 8" water line from NW Lyman Rd. to NW Paramore St.**





# Project Contact Information



**City of Topeka Public Works**  
David Bevens  
Community Education Manager  
620 SE Madison  
Topeka, KS 66607  
(785) 368-1642  
[dlbevans@topeka.org](mailto:dlbevans@topeka.org)



**SBB Engineering, LLC**  
Brian Austin, PE, PTOE  
Project Manager  
101 S Kansas Ave.  
Topeka, KS 66603  
Ph: 785-215-8630  
[brian.austin@sbbeng.com](mailto:brian.austin@sbbeng.com)



# North Topeka West Neighborhood Plan

Adopted 2/26/2016

## Public Facilities & Services Goal:

“Provide infrastructure and improvements to the North Topeka West neighborhood that demonstrate vitality and commitment to continued improvements in the quality of life of the residents.”

“Improvements to this street are a high priority of the neighborhood and should be implemented as soon as funding is secured.”

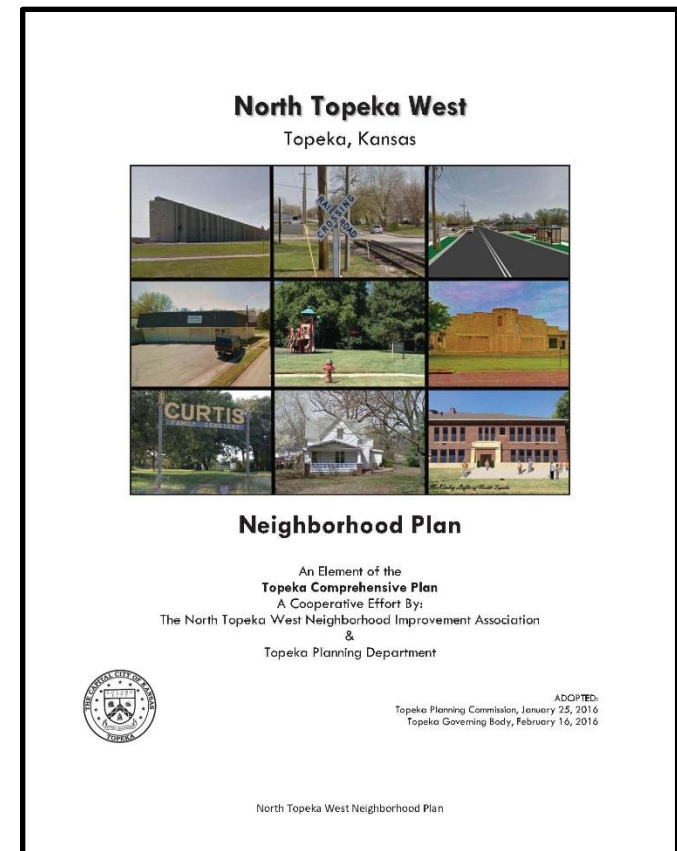



# **North Topeka West Neighborhood Plan**

## **Guiding Principles**

### **Guiding Principles:**

- **Create a pedestrian corridor using “Complete Streets” principles**
- **Capacity to support future development**
- **Make parks and trails more visible, accessible, and ‘kid friendly’**
- **Eliminate ditches and add curb & gutter**
- **Create pedestrian streetscapes and connect to amenities**
- **Reduce truck traffic**
- **Lower vehicle speeds**
- **Use appropriate street width**



← North

Lyman Rd.

Paramore St.

10' Shared Use Path

NW Tyler Rd.

Phase 1 - 2022

Phase 2 - 2025

Beverly St.



# 2022 – Phase 1A

Install 8" Water Line from

NW Lyman to NW Seaman St.

14 Days – February/March 2022

NW Tyler St. Remains Open to Local Traffic

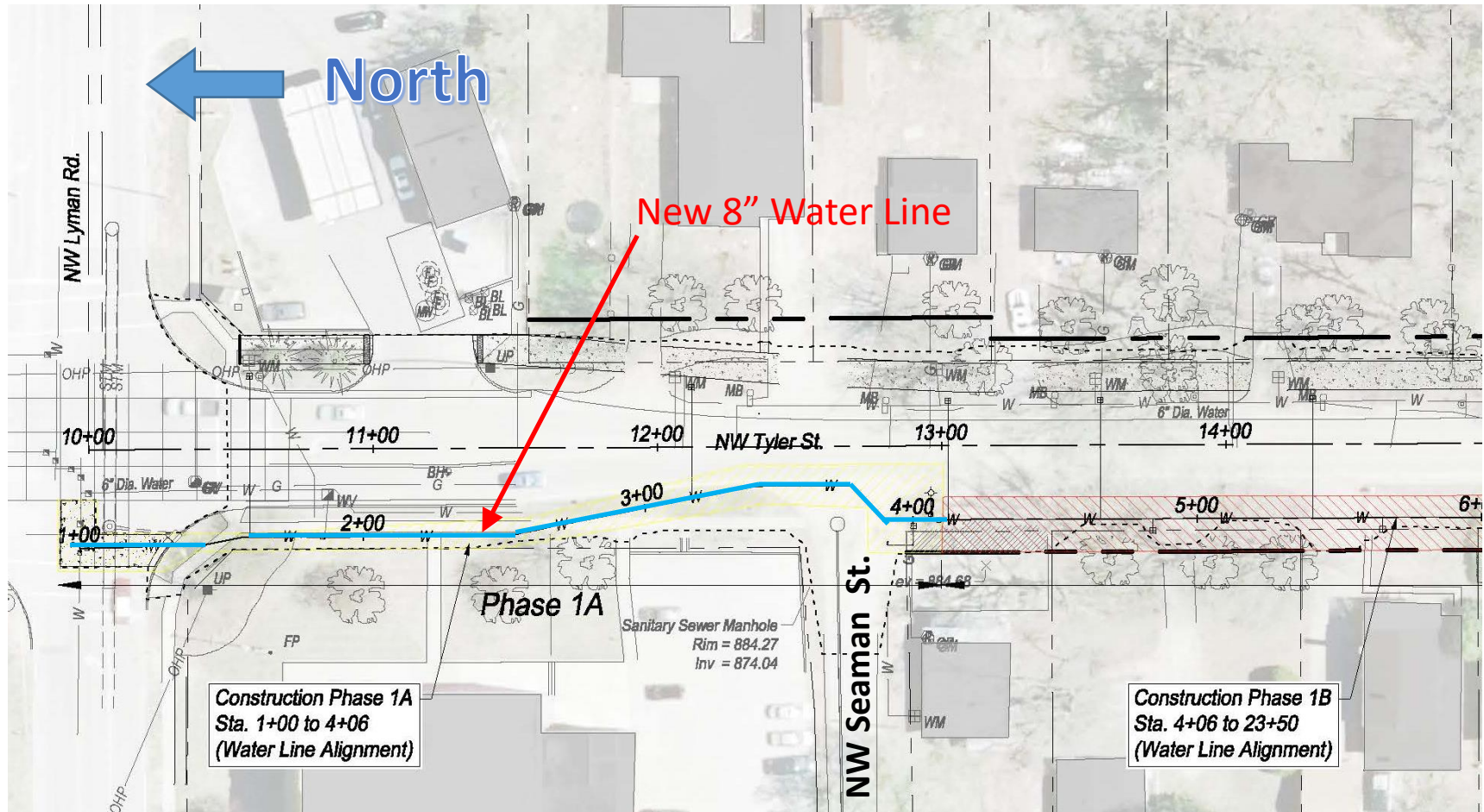

# 2022 – Phase 1B

Install 8" Water Line from  
NW Seaman St. to NW Paramore St.  
14 Days – February/March 2022  
NW Tyler St. Remains Open to Local Traffic

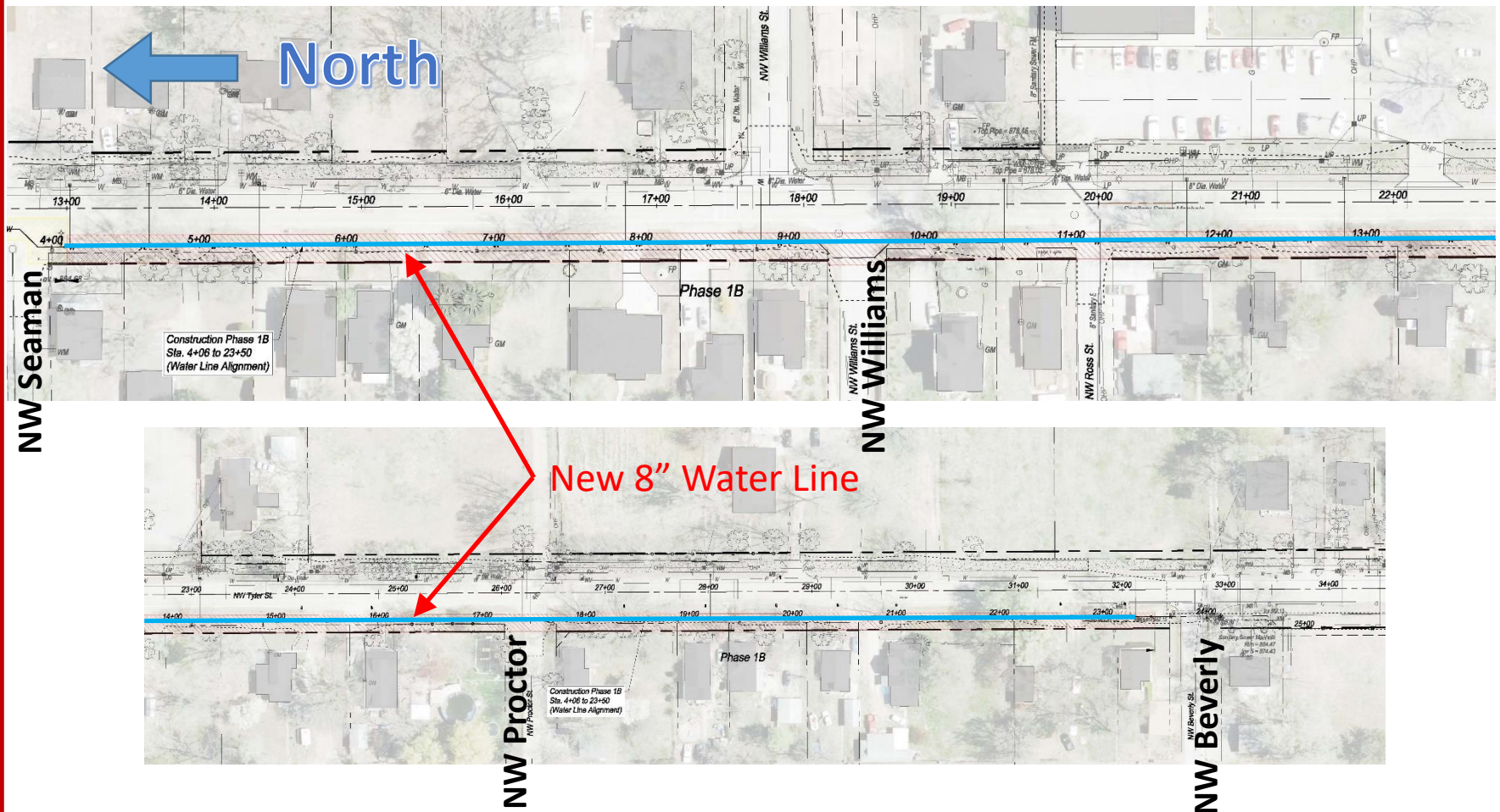



# 2022 – Phase 2A

**Install 8" Water Line from  
NW Beverly St. to NW Paramore St.  
90 Days – March to June 2022**

**Construct NW Tyler from NW  
Seaman St. to Great Life/YMCA  
90 Days – March to June 2022**

**NW Tyler St. Closed to Traffic. Residents Access  
Properties Via 10' Temporary Access Roads**

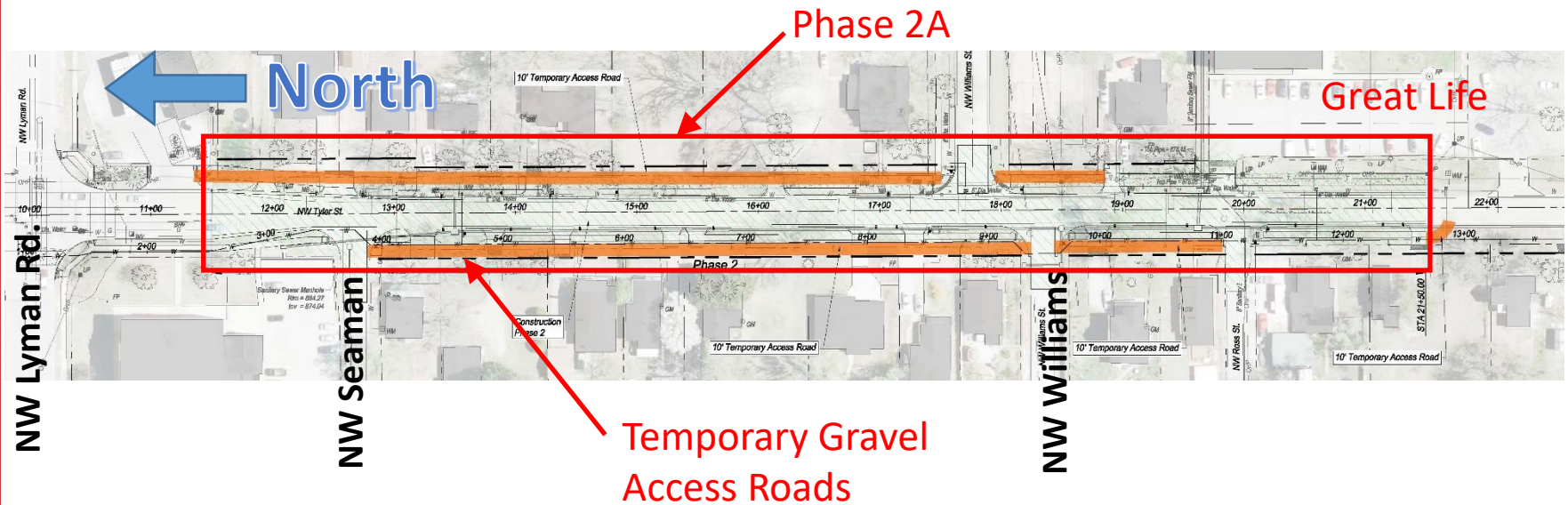



# 2022 – Phase 2B

Construct side roads:

NW Seaman St.

NW Williams St.

NW Ross St.

30 Days – June/July 2022

Open NW Tyler North of NW Proctor to Traffic.  
Remove Phase 2A Temporary Access Roads

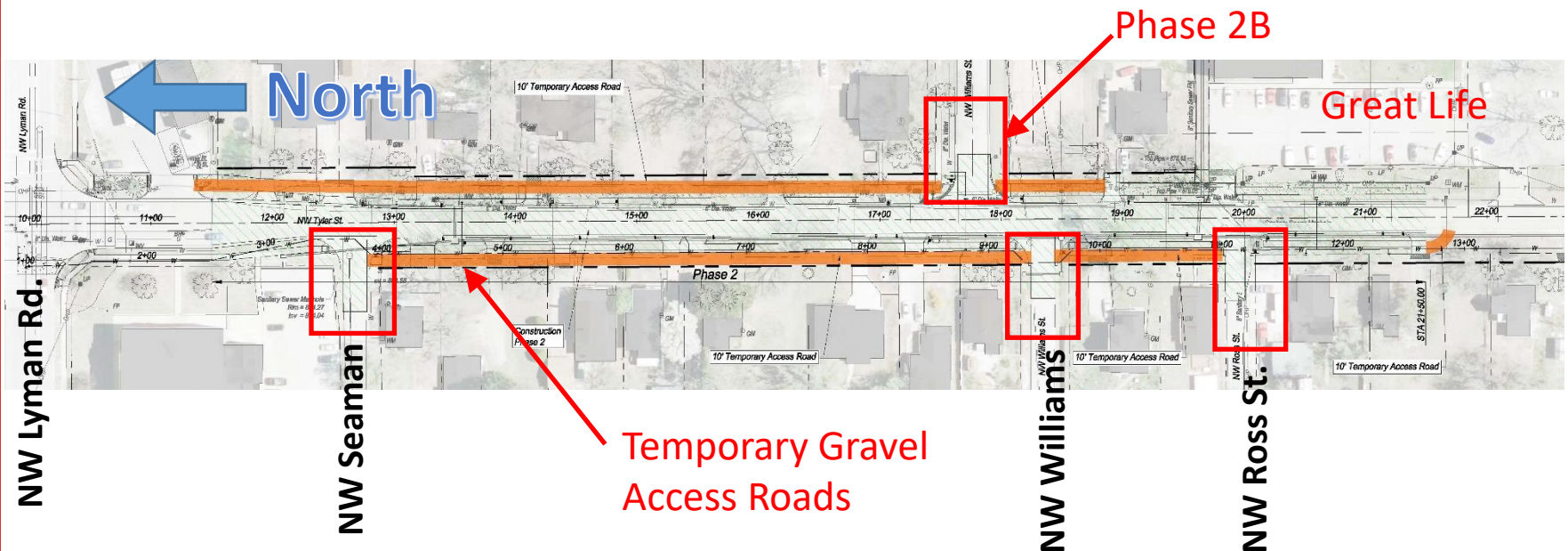

# 2022 – Phase 3

**Construct NW Tyler from Great Life  
Recreation Center to NW Beverly St.**

**NW Tyler St. Closed to Traffic. Residents Access  
Properties Via 10' Temporary Access Roads**

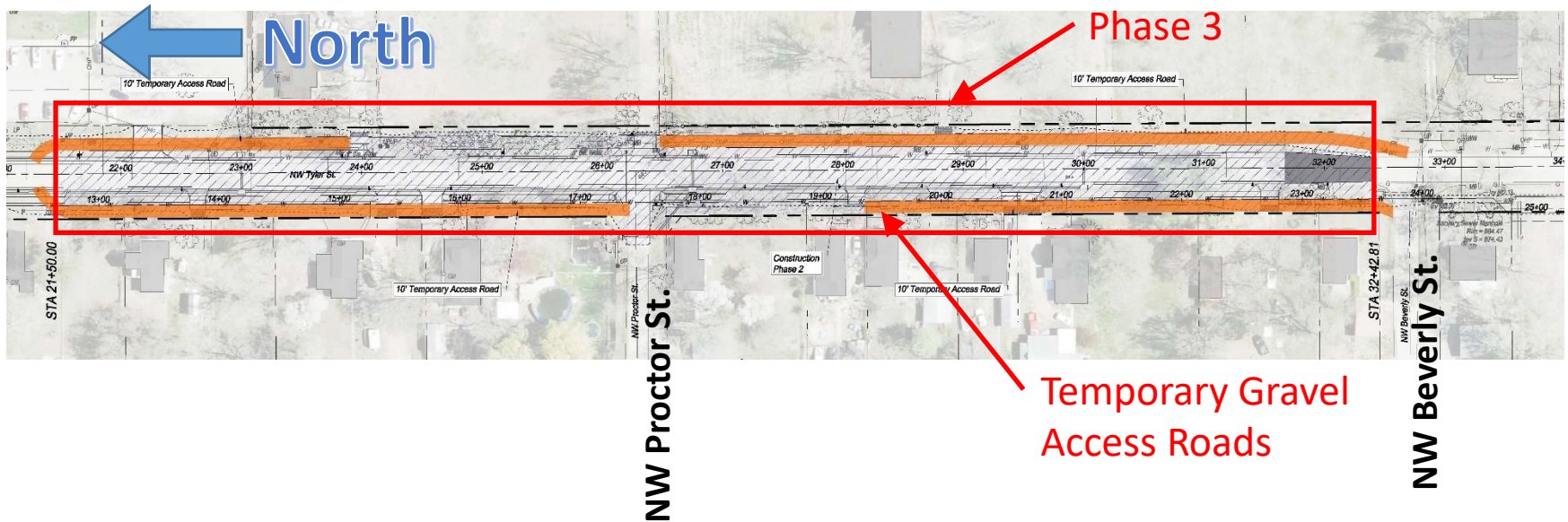



# NW Tyler Detour Route

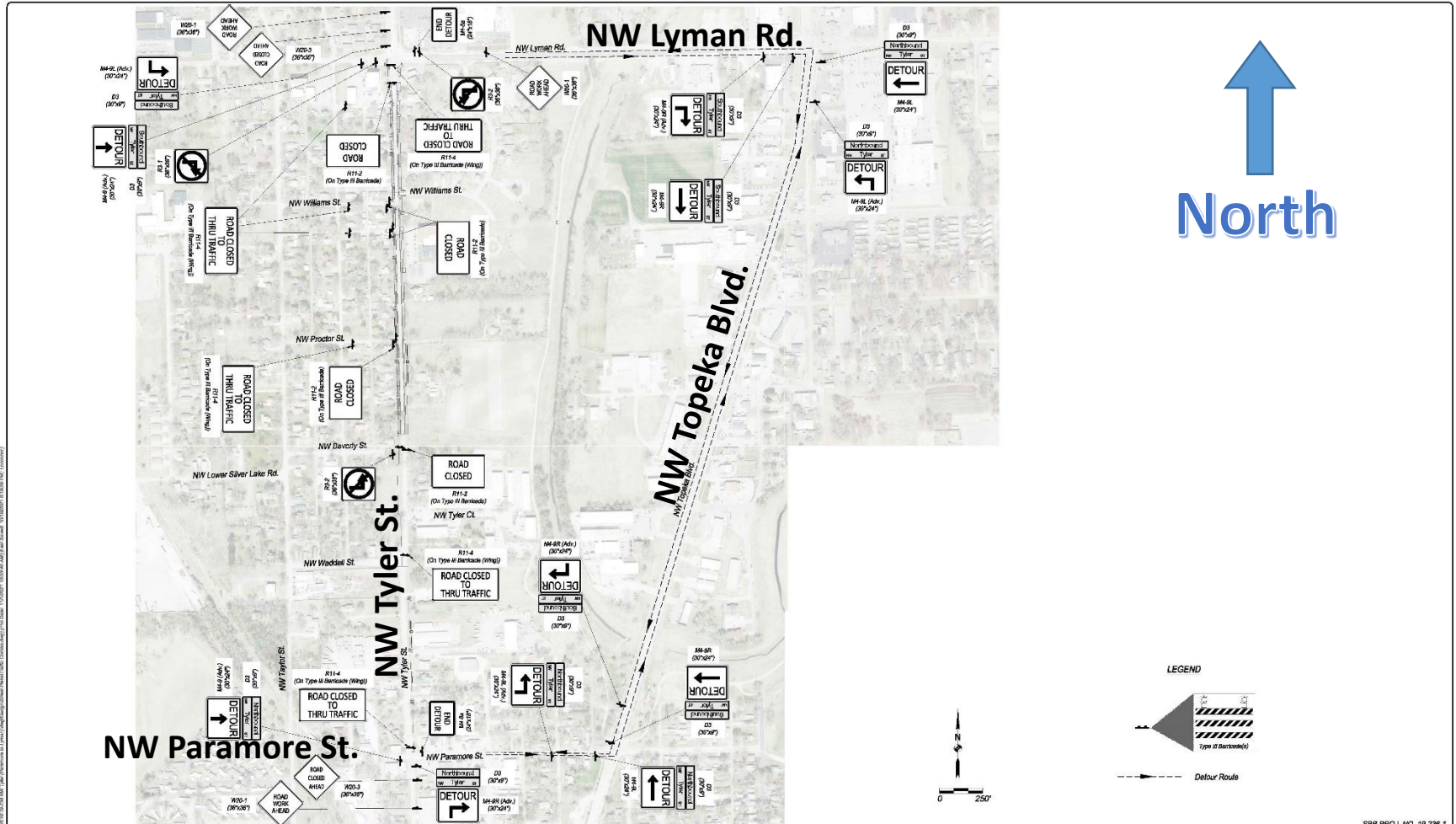

					DRAWN BY: L. O'CONNOR				<b>SBB Engineering, LLC</b> 101 S Kansas Ave., Topeka, KS 66603 Ph: (785) 215-6630 www.sbbeng.com	T-701019.00 and T-281225.04 NW Tyler Street Reconstruction (NW Lyman Rd. to NW Beverly St.)	Traffic Control & Detour Plan Phases 1 - 3	DATE: 11/1/2021 SHEET: 70 OF 94 PROJ.: T-701019.00
					APP'D BY: B. AUSTIN							
					FIELD BOOKS: -							
					SURVEYED BY: SBB ENG.							
NO.	DATE	REVISION	BY	APP'D								



## Next Steps

2021 – Design, Easement Acquisition, and Utility Relocation

2022 – Phase 1 (Lyman to Beverly)

2025 – Phase 2 (Beverly to Paramore)

You may provide comments at [TylerProject@Topeka.org](mailto:TylerProject@Topeka.org).

A project website is available at:

<https://www.topeka.org/streetmaintenance/nw-tyler-street/>.

### City of Topeka Public Works

David Bevens  
Community Education Manager  
620 SE Madison  
Topeka, KS 66607  
(785) 368-1642  
[dlbevans@topeka.org](mailto:dlbevans@topeka.org)

### City of Topeka Engineering

Kristi Ericksen, PE  
City Project Manager  
620 SE Madison  
Topeka, KS 66607  
(785) 368-3842  
[kericksen@topeka.org](mailto:kericksen@topeka.org)

### SBB Engineering, LLC

Brian Austin, PE, PTOE  
Project Manager  
101 S Kansas Ave.  
Topeka, KS 66603  
Ph: 785-215-8630  
[brian.austin@sbbeng.com](mailto:brian.austin@sbbeng.com)