

NOTICE OF NEIGHBORHOOD INFORMATION MEETING

Based upon the action requested below, the City of Topeka Planning Division is requiring the applicant to hold a neighborhood information meeting prior to the Planning Commission public hearing at the date, time, and location below.

May 22, 2023 at 6:00PM

Patterson Family Child Care

2347 SE Wisconsin Ave, Topeka, KS 66605

You have been identified as an owner of record within **300'** of the project boundary. The public is invited to attend this meeting to obtain more information from the applicant and have an opportunity to ask questions.

Project information

Case Number: CU23/01 by Patterson Family Infant & Toddler Center LLC

Action Requested: A Conditional Use Permit to allow for a Day Care Facility Type II at the southwest corner of SE Lott St & SE Wisconsin Ave.

Applicant Representative: Melissa Patterson – 785-249-3204 - pfccpp@gmail.com

Applicant: Patterson Family Infant & Toddler Center LLC

Location of Development: Southwest corner of SE Lott St & SE Wisconsin Ave

Existing Zoning: "R-2" Single-Family Dwelling District

Council District: Council District 4 – Tony Emerson

Planning Commission Public Hearing: *Tentative* – June 26, 2023, 6:00PM in City Council Chambers. Signage will be posted on the property indicating date of public hearing. Agenda information will be available at www.TopekaSpeaks.org and the meeting will be livestreamed from the TopekaSpeaks meeting page.

Prior to the Planning Commission meeting, questions and/or comments may be submitted through TopekaSpeaks.org.

Planning staff contact:

City of Topeka Planning & Development Department

Attn: William Sharp

620 SE Madison St, 3rd Floor, Topeka KS 66607 | 785.368.3728 or wjsharp@topeka.org

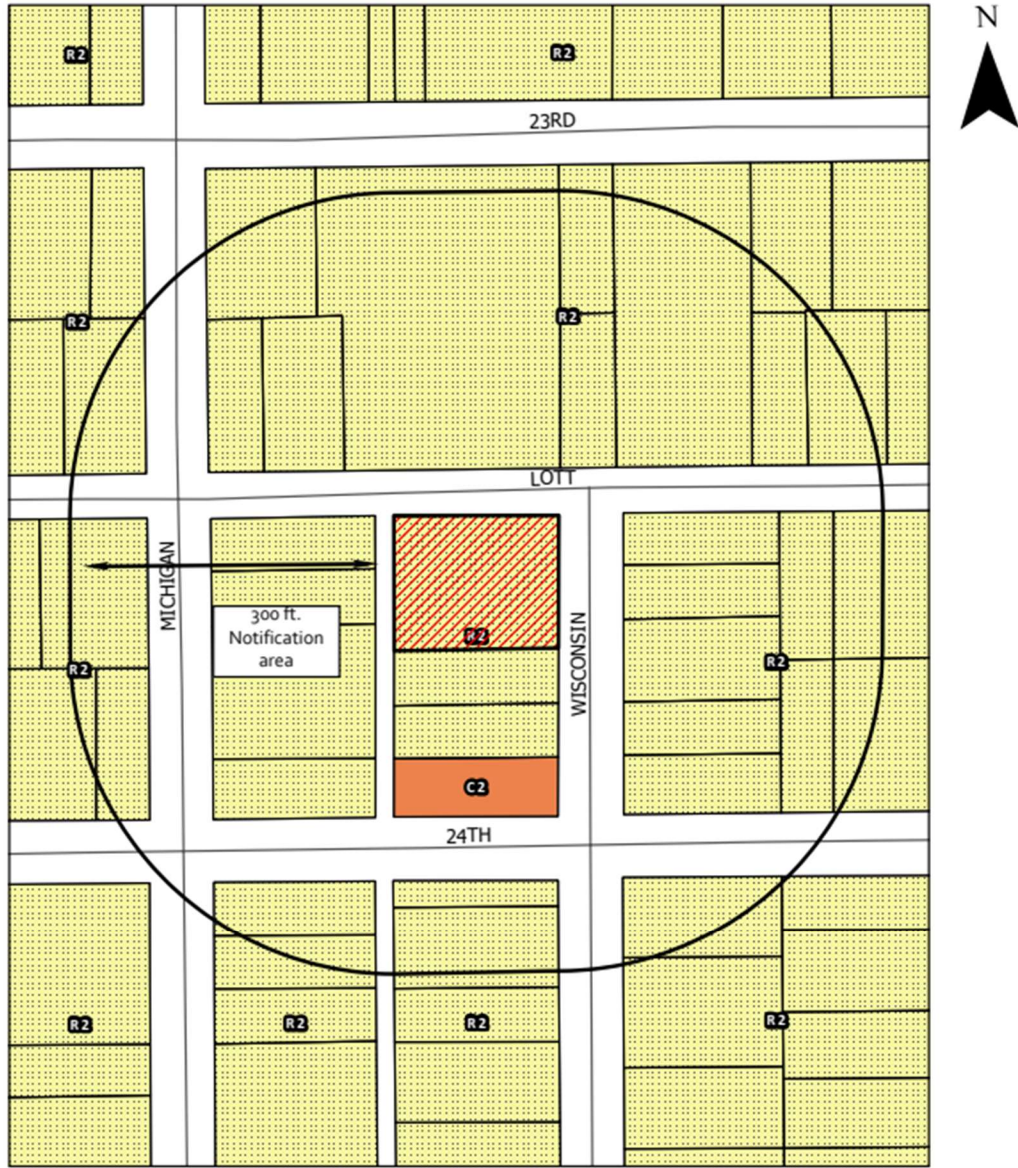

Topeka Planning Division

NIM Notification Map

 Subject Property